

Resort

Enjoy Your Stay...



Visit HEARTLAND on:





Model 441 FL



Model 441 FL



Resort

All the conveniences and comforts of home, modern construction techniques using quality building materials, residential household appliances, huge amounts of storage make **Resort** the perfect, affordable way to enjoy favorite vacation spots for extended times.

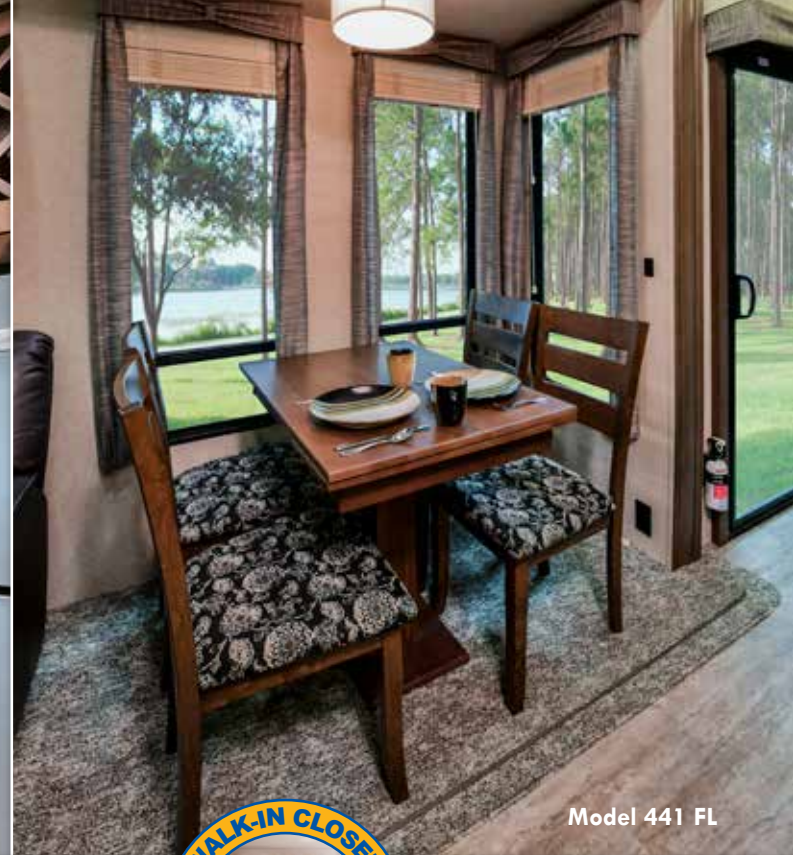

Model 441 FL



Model 441 FL

Move to
Enjoy...

Featuring deluxe appliances, generous storage cabinets with designer hardware, full extension ball bearing drawer guides and spacious work areas, **Resort** kitchens are truly designed for the cook in your family.



Model 441 FL



Model 441 FL

Resort



Model 340 FE



Model 340 FE

Your Favorite Destination Awaits

* Photos may show optional equipment.



Model 340 FE



Model 340 FE



Model 340 FE



Model 340 FE



Model 340 FE



Residential Appliances



High-Rise Pull-out Kitchen Faucet



LED Ceiling Lighting



Tri-Fold Sleeper Sofa



Under-Bed Storage



Dinette Seat Storage



Laminated Sidewall Construction

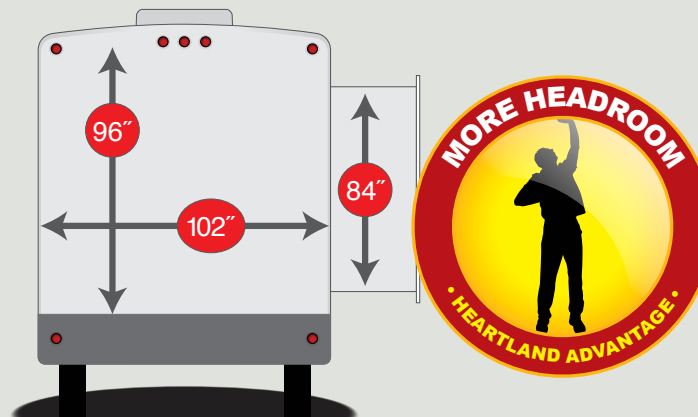

Epic Proportions - Height and Width



Fireplace

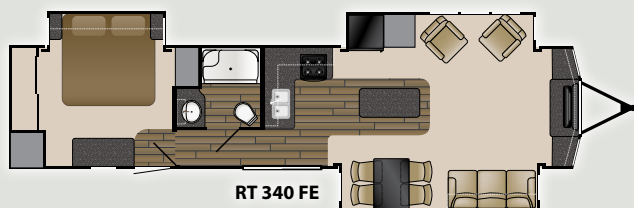

RT 340 FE

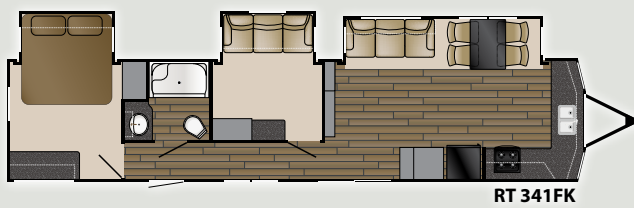

RT 341 FK

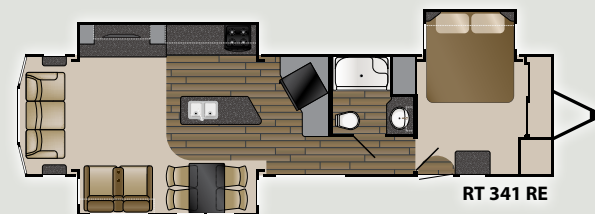

RT 341 RE

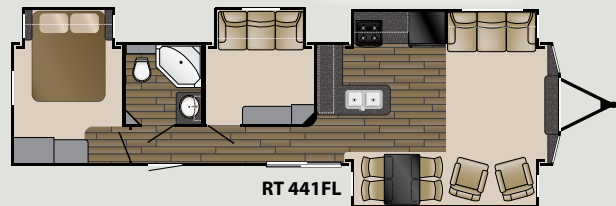

RT 441 FL

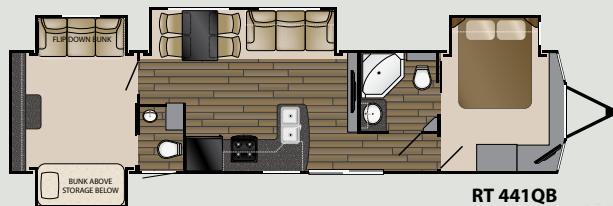

RT 441 QB

MODEL	340 FE	341 FK	341 RE	441 FL	441 QB
LENGTH with Hitch	41' 8"	42' 11"	41' 0"	40' 10"	41' 2"
BOX LENGTH	37' 11"	39' 3"	37' 3"	37' 2"	37' 6"
HEIGHT	12' 9"	12' 9"	12' 9"	12' 9"	12' 9"
WIDTH	8' 6"	8' 6"	8' 6"	8' 6"	8' 6"
WEIGHT	11,024	11,190	11,020	11,112	11,222
LP	2 x 30 LB	2 x 30 LB	2 x 30 LB	2 x 30 LB	2 x 30 LB
TANKS	41 ^F 111 ^G 37 ^B	41 ^F 74 ^G 37 ^B	41 ^F 111 ^G 37 ^B	41 ^F 74 ^G 37 ^B	41 ^F 74 ^G 74 ^B



Higher Standards

Resort Destination Camping Package:

- Fiberglass Wrapped Bay Front
- Jensen DVD/CD/AM-FM/MPS W/Bluetooth Player
- (4) Interior & (2) Exterior Speakers
- Skylight Over the Shower
- Outside Shower
- Detachable Hitch
- Heated & Enclosed Underbelly
- 8' Interior Ceiling Height
- 102" Wide Body Construction
- 7' Interior Slide-Out Height
- 12" Dual I-Beam Frame
- Coated Slide Out Room Floors
- 5/8" Thick Flooring (Main Body)
- Full Walk-On Roof With One Piece TPO Membrane
- Metal Exterior Siding w/Lakeview Graphics
- R-7 Roof & Floor Fiberglass Insulation
- Dinette Storage Table W/10" Leaf & (4) Storage Chairs
- 60"x 78" Tinted Patio Door

Resort Standard Interior Features:

- Residential Grade Carpets
- High Quality Beau Vinyl flooring
- Raised Panel Upper Cabinet Doors in Kitchen
- 2" White Wooden Window Blinds, Living room
- Gas Strut Lift-Up Under Bed Storage
- Porcelain Toilet w/Foot Flush
- Black Tank Flush
- Washer/Dryer Prep (Most models)
- Glass Shower Door
- Full Size Tri-Fold Sleeper Sofa
- Swivel/Rocker/Recliners or (1) Theater Seat
- Queen Mattress, w/Comforter and Headboard (Master)
- High Rise Kitchen Faucet W/Pull Down
- Maximum Counter Space W/Abundant Storage
- 48" Jensen LCD TV W/Powered Lift Up (RT340FE Only)
- Dual 30lb LP Tanks

Resort Standard Convenience Features:

- 50 Amp Electric Service W/Detachable Cord
- LED High Output Ceiling Lights
- Electric Fireplace W/5000 BTU Heater
- Central Vacuum W/Attachments
- 4- Burner 20" Freestanding Gas Range w/ Oven
- Two Door Residential Refrigerator w/Glass Shelves
- Exterior Under Bed Storage
- 30" Over the Range Microwave, Vented
- 10 Gallon Gas/Electric W/DSI Water Heater
- 40,000 BTU In Floor Ducted Gas Furnace
- 15,000 BTU Dual "H" Ducted A/C w/Chill Grille
- Braced/Wired/Prepped for Second A/C in Master Bedroom
- Residential Ceiling Fans in Living Room & Master Bedroom
- XL Swing Door Handle at Patio Door

OPTIONS

- Dual Pane Windows (Does Not Include Doors)
- Maximum Lino (Retain Carpet in Slide-outs)
- Coffered Ceiling
- 4 Stabilizer Jacks
- Electric Patio Awning W/LED Lighting
- Residential Toilet (No Gray or Black Tanks)
- Fresh Water Holding Tank W/110V Pump
- Jensen, Powered Sound Bar
- Jensen, 48" LCD TV
- King Mattress IPO Queen, Master Bedroom
- 13.5 K BTU A/C in Master Bedroom
- CSA Construction Certification & Seal

PLATINUM PACKAGE

- Fiberglass Laminated Sidewalls
- Stainless Steel Appliances
- Solid Surface Counter Tops in Galley
- Double Bowl Stainless Steel Kitchen Sink
- Kitchen Sink Bowl Covers
- High Rise Kitchen Faucet W/Pull Down



Heartland Recreational Vehicles
2831 Dexter Drive • Elkhart, IN 46514 • 574-262-5992

Community. Convenience. Close-to-home.

Where you purchase your recreational vehicle is ultimately your decision but Heartland urges you to consider buying at your local dealer. Dealers are part of your community, providing jobs and contributing to your local economy. These dealers are under obligation to provide warranty service for products they sell, but are not legally required to service products purchased from other dealers. At some point, you may need to return to the dealer you buy from - why not stay close to home? After all, home is where your Heartland is!

BENEFITS OF PURCHASING YOUR RV LOCALLY:

- You enjoy valuable relationship building with Dealer Representatives, close to your home, who will explain the features and benefits of the product.
- You receive a full product orientation prior to delivery, which includes hands-on directions for many of the coach's systems and functions. You are also introduced to the Dealership's Service/Parts/Warranty personnel who are at the ready to help you with any issues you may encounter, now and in the future.
- You enjoy customer PRIORITY. Dealerships generally service their purchasing customers first - others may experience long delays and miss opportunities to use their RV. What is it worth for you to have a dealership's full attention and motivation to satisfy you when you need service - in a timely manner?
- Valuable TAX dollars and jobs stay in YOUR community which pays for your roads, schools, police and fire departments.

DON'T UNDERESTIMATE CUSTOMER SERVICE AND PERSONAL CARE!

For Canadian Residents: If you purchase an RV out-of-country, there are additional fees, taxes and inspections that must be met before bringing your product home. Your local Canadian dealers are experts in these provisions.

Visit HEARTLAND on:



Your Authorized Heartland Dealer:

HEARTLAND PROUDLY PARTNERS WITH THE HIGHEST QUALITY VENDORS
in manufacturing our recreational vehicles:



Resort

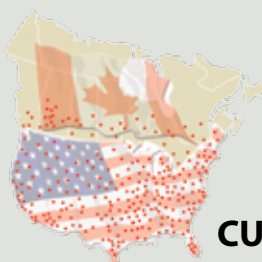

HEARTLAND CUSTOMER SERVICE WE'VE GOT YOUR BACK!

Over 40 men and women located in a dedicated facility servicing our customers every day. With a dealer network of over 400 locations across the U.S. and Canada, you're never far from an authorized Heartland dealer.

www.HEARTLANDRVs.com

Experience:
Product Walk-Through Videos
Side By Side Comparisons
Feature Videos • Photo Galleries
Virtual 360° Tours
Detailed Floor Plans
News • Testimonials
Dealer Locator • Owners Club
Customer Service • Service Locator
and More at our Informative Web Site

www.heartlandrvs.com
• FOR ADDITIONAL INFORMATION •

Product information is as accurate as possible as of the date of publication of this brochure. Due to Heartland's commitment to continuous product improvement - floorplans, materials, components, features, measurements, specifications, options, etc. are subject to change at any time without notice or obligation. In certain conditions some additional equipment may be needed. Photos may show optional equipment or props used for photography purposes only.

Heartland has listed the approximate base weight of the trailer without the option equipment included. Option equipment will impact the weight of the trailer. Please locate the weight sticker attached to the trailer you are considering for the most accurate trailer weight.

Tow Vehicle Caution: Owners of Heartland recreational vehicles are solely responsible for the selection and proper use of tow vehicles. All customers should consult with a motor vehicle manufacturer or their dealer concerning the purchase and use of suitable tow vehicles for Heartland products. Heartland disclaims any liability or damages suffered as a result of the selection, operation, use or misuse of a tow vehicle. Heartland's limited warranty does not cover damage to the recreational vehicle or the tow vehicle as a result of the selection of the tow vehicle.